

**Verschlussstopfen**

metallisch dichtend

**Blanking plugs**

metal-metal sealing

**Tapones**

cierre metal/metal

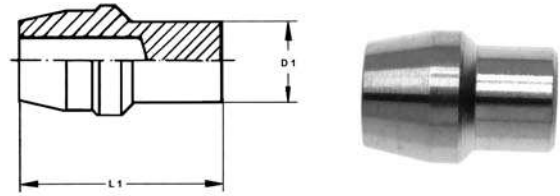
**VOE-..L/S**

Type	Mat.-Nr.	Serie	PN	D1	L1	g/Stk
VOE-06L/S	706.0033.060.13	L/S	630	6	17.5	11
VOE-08L/S	706.0033.080.13	L/S	630	8	18.5	13
VOE-10L/S	706.0033.100.13	L/S	630	10	19.5	17
VOE-12L/S	706.0033.120.13	L/S	630	12	19.5	22
VOE-15L	706.0033.150.20	L	315	15	19.5	24
VOE-18L	706.0033.180.20	L	315	18	20.0	31
VOE-22L	706.0033.220.20	L	160	22	20.5	52
VOE-28L	706.0033.280.20	L	160	28	21.5	97
VOE-35L	706.0033.350.20	L	160	35	23.5	176
VOE-42L	706.0033.420.20	L	160	42	25.0	234
VOE-14S	706.0033.140.30	S	630	14	20.0	24
VOE-16S	706.0033.160.30	S	400	16	21.0	34
VOE-20S	706.0033.200.30	S	400	20	24.0	57
VOE-25S	706.0033.250.30	S	400	25	25.0	104
VOE-30S	706.0033.300.30	S	400	30	26.5	151
VOE-38S	706.0033.380.30	S	315	38	30.0	213

 passend in 24°-Innenkonus  
 (Bohrungsform W DIN 3861)

 fitting type 24° inside tapers  
 (bore type W DIN 3861)

 encaja en cono interior de 24°  
 (forma de taladro W DIN 3861)

**LEHENGOMAK, S. A.**